

Hotel Moorea Pearl Resort & Spa - 4*

In a short drive from arrival points on the island, just by the village of Maharepa, its small shopping center close at hand, and 2kms from the Golf of Moorea, you will find a traditional Polynesian style and convivial resort on a human scale, offering a warm welcome to romantic couples, families, nature lovers and scuba-divers.

Enjoy the privacy of the flowering Garden Pool Bungalows and put a toe out to try Spa, dive center, jet ski, large swimming pool, boutique, main or gourmet restaurant... Near the overwater bungalows, the hotel has also developed his own coral regeneration project, the To'A Nui nursery you can easily enjoy with simple snorkeling equipment.

Location

10 min from airport

15 min from pier

5 min from Moorea Golf course

Transfer by bus or private car with our services



Welcome amenities: Welcome cocktail and refreshing towel

Specified Welcome Gifts may be replaced without notice by others with same value.



Room Categories

22	Garden View Room	3A or 2A+2C	
8	Garden View Duplex	4A+1Inf	
28	Premium Garden Pool Bungalow	3A or 2A+2C	Our Preferred Category! Wheelchair accessible
2	Beach Bungalow	3A or 2A+2C	
6	Premium Beach Bungalow	3A or 2A+2C	
8	Overwater Bungalow	3A or 2A+2C	
20	Premium Overwater Bungalow	3A or 2A+2C	

Important! Maximum occupancies indicated above are valid until March 31st, 2013.

From April 1st, 2013, all categories will be able to accommodate 3A+1C, 4A+1C for the Garden View Duplex.

Check in 14h00 - Check out 11h00

Dining - Entertainment Features

MAHANA'I - Seafood, Local & International Cuisine

Breakfast 06H30 - 10H00, Lunch 12H00 - 14H00, Dinner 18H30 - 21H30

Snack 14H00 - 21H30 (on Wednesday & Saturday 14H00 - 16H30 only)

Polynesian buffet with Show on Wednesday

International buffet with Show on Saturday

LE MATIEHANI - Grill party on the beach

Dinner only 18H30 - 21H00 on Monday, Tuesday, Thursday & Friday

Room Service available 6H30 - 10H30 / 12H00 - 21H30

AUTERA'A 10H00 - 23H00

3 conference rooms available : theatre style (100 pax), banquet style (72 pax), classroom style (65 pax)

Facilities and Activities

Info Internet

2 computers at the lobby. Wi-fi connection in all the property and in your room/bungalow (with your own lap top). 4€ / 1hour

Tours and activities desk open 7H30 - 16H30 everyday

Moorea Blue Diving Center 07H00 - 08H00 and 11H30 - 16H30

Toanui Coral Nursery a coral regeneration project to be discovered with snorkeling gear down the overwater bungalows

Manea Spa : Massages, Polynesian Tattoo, Body Care, Facial Care, Waxing, Steam Bath, Aquatic massages. Open everyday 9H00 - 19H00

Free activities: Badminton, Beach Towels Provided, Kayaks, Canoe, Petanque, Snorkeling Equipment, Tennis Table, Volleyball,

Other Facilities: Power Adaptor 220V-110V, Baby Sitting, Boutiques, Dive Center, Ice Machine, Infinity Pool, Internet Access / Wifi, Jacuzzi, Laundry Service, Spa, Tour Desk, Transit Rooms,

Exclusive Services

Romantic Touches such as Flower lei, Fruit Basket, Champagne, Wine...

Romantic Excursions as the Private Romantic Day Cruise

Romantic Dinners as a dinner under the stars

Weddings Ceremonies on the beach, with different services

Children

Set of toys available such as beach toys, rake, spade, bucket and various games. Children life jackets, children size snorkeling gear. In room, welcome candies basket. Children menu at restaurant.

Important Remarks

Information on this Factsheet is subject to change without prior notice.

Accepted Credit Cards at the Resort - Visa, Mastercard, American Express, Diners Club, JCB



- A - Reception
Hall
Boutique
- B - Conference center
- C - Restaurant "Mahanaï"
Gourmet restaurant "Le Matiehani"
- D - Bar "Autera'a"
- E - Manea Spa
MANEA
SPA
- F - Garden View Room and Garden View Duplex
Chambre Vue Jardin et Duplex Vue Jardin

- G - Garden Pool Bungalows - *Bungalows Jardin avec Piscine*
- H - Beach Bungalows - *Bungalows Plage*
Diving center - *Centre de plongée*
- I - Premium Beach Bungalows
Bungalows Plage Premium
- J - Overwater Bungalows
Bungalows Pilotis
- K - Premium Overwater Bungalows
Bungalows Pilotis Premium
- L - Swimming Pool - *Piscine*

MOOREA PEARL RESORT & SPA

Room Facilities

Air Conditioning, Cable TV, Coffee / Tea Facilities, Connecting Rooms, DVD/CD Player, Hair Dryer, In Room Internet Access, Iron, iPod Station, Mini Bar, In Room Safety Box, Telephone,

Garden View Room

These units are located in the main building (1st and 2nd floor) and have a nice view on the luxurious garden.



From April 1st, 2013, maximum occupancy will be 3A+1C

Maximum Occupancy: 3A or 2A+2C

Bed Configuration: 1 king bed or 2 single beds + 1 sofa bed (+ 1 rollaway bed from April 1st, 2013)

More Info: Surface 44m²

Additional facilities: Connecting Rooms, Shower, Terrace,

Garden View Duplex

The Garden View Duplex are perfect for families in so far as they feature a mezzanine and welcome up to 4 persons.

From April 1st, 2013, maximum occupancy will be 4A+1C

Maximum Occupancy: 4A+1Inf

Bed Configuration: 1 king bed + 2 single beds (+ 1 baby bed until March 31st, 2013 OR + 1 rollaway bed from April 1st, 2013)

More Info: Surface 59m²

Additional facilities: Shower,

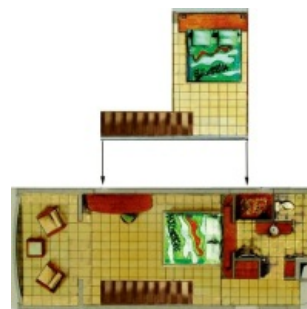

Premium Garden Pool Bungalow

The Premium Garden Pool Bungalows have a small private pool on the veranda. The garden bungalows feature one king bed and one single bed and a patio with garden view. They are located at the garden.

Wheelchair access

From April 1st, 2013, maximum occupancy will be 3A+1C

Maximum Occupancy: 3A or 2A+2C

Bed Configuration: 1 king bed or 2 single beds + 1 sofa bed (+ 1 rollaway bed from April 1st, 2013)

More Info: Surface 48m²

Additional facilities: Connecting Rooms, Private Pool, Shower,

Beach Bungalow

The 2 Beach Bungalows are located next to the restaurant, near the activities centre. These units stand on a white sand beach, just a few meters from the lagoon.

From April 1st, 2013, maximum occupancy will be 3A+1C

Maximum Occupancy: 3A or 2A+2C

Bed Configuration: 1 king bed or 2 single beds + 1 sofa bed (+ 1 rollaway bed from April 1st, 2013)

More Info: Surface 44m²

Additional facilities: Shower,



Premium Beach Bungalow

The Premium Beach Bungalows are located on a lovely stretch of sand, right on the beach.

From April 1st, 2013, maximum occupancy will be 3A+1C

Maximum Occupancy: 3A or 2A+2C

Bed Configuration: 1 king bed or 2 single beds + 1 sofa bed (+ 1 rollaway bed from April 1st, 2013)

Additional facilities: Shower,



Overwater Bungalow

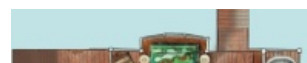

The Overwater Bungalows are all facing the beach and the mountain. From their private terrace you have direct access to the lagoon.

From April 1st, 2013, maximum occupancy will be 3A+1C

Maximum Occupancy: 3A or 2A+2C

Bed Configuration: 1 king bed + 1 sofa bed (+ 1 rollaway bed from April 1st, 2013)

More Info: Surface 48m²

Additional facilities: Bathtub, Private Ladder to Lagoon, Glass Bottom Table,



Premium Overwater Bungalow

The Premium Overwater bungalows are well appointed and have a panoramic view of the blue lagoon of Moorea. These bungalows have a sundeck and sitting area with direct access to the lagoon.

From April 1st, 2013, maximum occupancy will be 3A+1C

Maximum Occupancy: 3A or 2A+2C

Bed Configuration: 1 king bed + 1 sofa bed (+ 1 rollaway bed from April 1st, 2013)

More Info: Surface 48m²

Additional facilities: Bathtub, Private Ladder to Lagoon, Glass Bottom Table,

